



TAPCON[®] XL







Extra Large Tapcon for Extra Large Challenges!

High performance large diameter masonry anchor provides twice the strength of standard Tapcon and the premium corrosion protection of UltraShield™.



HEAVY DUTY MASONRY APPLICATIONS

Applications

-  Shutters - protective and decorative
-  Screened Porch and Pool Enclosures
-  Railings
-  Mounted Electrical Equipment
-  Wood Nailers
-  Sill Plates

Product Features

-  Large 5/16" diameter provides maximum spacing and decreased labor costs.
-  Internal TORX[®] T-40 drive assures easy installation.
-  High button head resists cam-out during installation.
-  Reversed Hi-Lo[®] thread design provides maximum pullout values.
-  Premium corrosion protection of new UltraShield™ and White UltraShield™ to combat aggressive environments.
-  Available in silver, all white or white with head paint to complement standard fixtures.
-  Delivers twice the holding power of standard Tapcon in concrete and hollow block.
-  Replaces costly sleeve anchors.
-  1/4" SDS Tapcon drill bit for added convenience.
-  Condrixe[®] XL with MegaGrip™ bit holder for rapid one-tool installation.
-  100 count packaging for jobsite convenience.

Product Specifications

- Diameter**..... 5/16"
- Thread Form**..... Reversed Hi-Lo[®]
- Point Type**..... Nail
- Finish**..... UltraShield™, White UltraShield™

Corrosion Resistance

Salt Spray Results (ASTM B117)

- **UltraShield:**
1120 hours - 10% or less red rust
- **White UltraShield:**
1500 hours - 10% or less red rust

Head Styles

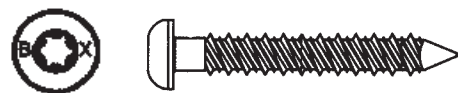

High Button with TORX T-40 Drive

Installation Bit Holder With Bit



MegaGrip Adjustable Magnetic Bit Holder with TORX T-40 Bit Tip
Part Number 3400910

PRODUCT REPORT No. 01081

Selector Guide



Anchor Description	Anchor Part Number	Carton Quantity	Drill Bit	Drill Bit Part Number	Anchor Finish
5/16 x 2-1/4"	3395902	800	1/4 x 6-3/4" SDS drill bit with hex	3394910	UltraShield™
5/16 x 2-1/4"	3397902	800	1/4 x 6-3/4" SDS drill bit with hex	3394910	*White UltraShield™
5/16 x 2-3/4"	3398902	800	1/4 x 6-3/4" SDS drill bit with hex	3394910	*White UltraShield™

*Head Paint Available

Part Number	Description	Carton Quantity
3401910	Condrive® XL Installation Tool with MegaGrip™ Bit Holder with TORX® T-40 Bit Tip	10 per master carton
3400910	MegaGrip™ Magnetized Bit Holder with TORX T-40 Bit Tip	10 per bag
3394910	1/4 x 6-3/4" SDS Tapcon Drill Bit with Hex	1 piece per tube

Tapcon XL Anchors must be installed using all Buildex system components (Tapcon XL Anchors, Condrive XL Installation Tool and Tapcon Drill Bits) in order to qualify for ITW Buildex system support.

Performance Data

EDGE DISTANCE	EMBEDMENT	CONCRETE		HOLLOW BLOCK W/ GROUTED CORE		HOLLOW BLOCK W/O GROUTED CORE		WOOD	
		PULLOUT	SHEAR	PULLOUT	SHEAR	PULLOUT	SHEAR	PULLOUT	SHEAR
1-9/16"	1.25"	1048	1332	-	-	-	-	-	-
2-3/16"	1.25"	1204	1724	-	-	-	-	-	-
3-1/8"	1.25"	1204	2172	-	-	-	-	-	-
4"	1.25"	-	-	-	-	1044	2280	-	-
1-9/16"	1.75"	2020	1528	-	-	-	-	-	-
1-3/4"	1.75"	-	-	-	-	-	-	1352	1248
2-3/16"	1.75"	2252	2504	-	-	-	-	-	-
3-1/8"	1.75"	2332	2508	-	-	-	-	-	-
4"	1.75"	-	-	1948	2824	-	-	-	-
1-9/16"	2.25"	2852	1956	-	-	-	-	-	-
2-3/16"	2.25"	3120	3248	-	-	-	-	-	-
3-1/8"	2.25"	3152	3408	-	-	-	-	-	-
4"	2.25"	-	-	3768	3140	-	-	-	-

Note:

- Concrete = 3000 psi minimum
- CMU 1600 psi minimum, with grout. cores minimum 2000 psi grout.
- CMU 1600 psi minimum, without grouted cores.
- Spruce-Pine-Fir Wood Substrate (G=0.36).
- Allowable Tension and Shear Values expressed in pounds (lbs.).

Note: Indicated pull-out and shear failure values were obtained in tests witnessed by Pittsburgh Testing Laboratory personnel. Designated holding power depends on the quality of the masonry material, depth of embedment and proper hole size. These figures are offered only as a guide and are not guaranteed in any way by Illinois Tool Works Inc. The figures indicate average ultimate pull-out and shear failure values. A safety factor of 4:1 or 25% of ultimate pull-out value is generally accepted as a safe working load. However, reference should always be made to applicable codes for the specific safe working ratio. All values are based on close tolerance holes drilled with Buildex SDS Tapcon® drill bits. Performance of the Tapcon anchor may vary in extremely hard concrete aggregates. Consult your Buildex representative for further information.

As in the case with all applications, Buildex can only suggest typical fasteners for typical applications and that the connection design is the sole responsibility of the Building Design Engineer, Architect or otherwise responsible person charged with the design of the connection. For further product information, please contact the nearest Authorized Buildex Distributor or the Buildex Technical Service Department at 1-800-323-0720.

Installation Guidelines Using Condrive® XL

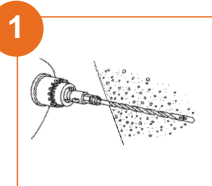

STEP 1: Place 1/4 x 6-3/4" SDS Tapcon drill bit in chuck of hammer drill. Drill hole a minimum of 1/4" deeper than Tapcon XL anchor is to be embedded. Remove excess debris from predrilled holes.

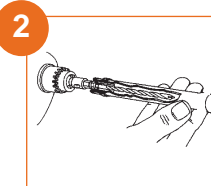

STEP 2: Insert the adjustable MegaGrip bit tip holder in the small opening of sleeve. Slide the open end of the Condrive XL Installation Tool sleeve over the drill bit and snap in place.



STEP 3: Drive anchor to secure.



1349 West Bryn Mawr Avenue
Itasca, Illinois 60143
630/595-3500 FAX: 630/595-3549
www.itwbuildex.com



Tapcon® XL, Condrive® XL, UltraShield™, White UltraShield™, Hi-Lo®, MegaGrip™, Building Ideas that Work®, are all trademarks of ITW Buildex and Illinois Tool Works Inc.

TORX® is a registered trademark of Textron Inc.
© 2009 Illinois Tool Works Inc.